

**DUSK, ONGAR ROAD, PILGRIMS HATCH CM15 9SS**

# **APPENDIX 2**

**Premises Licence 1 October 2019**

**OS Maps & Images**

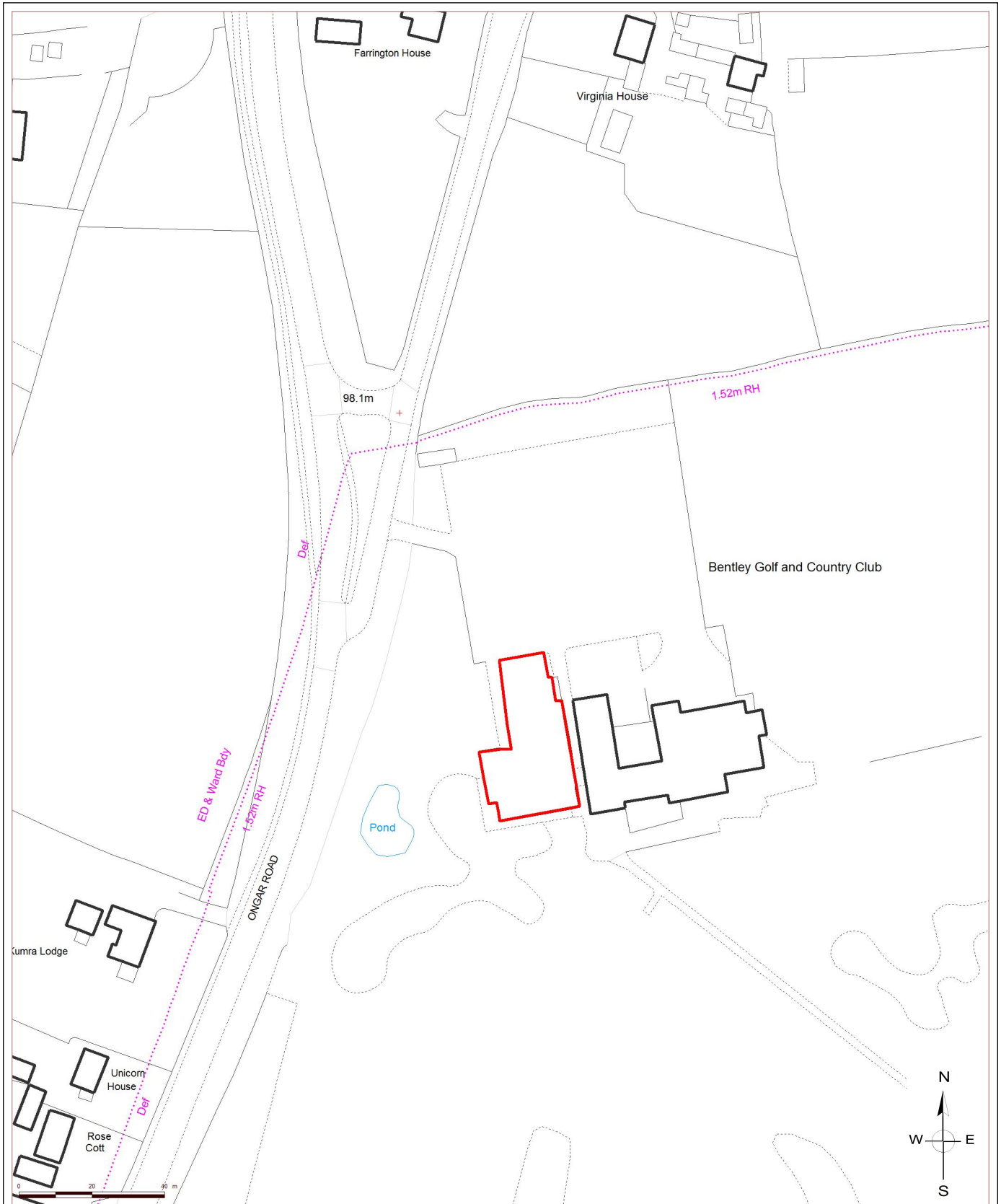

# DUSK, ONGAR ROAD, PILGRIMS HATCH CM15 9SS



Drawing No. :  
 Scale at A4 : 1:1500  
 Drawn by : OSJ  
 Service : ICT  
 Date : 19th August 2019

© Crown copyright and database rights 2018 Ordnance Survey 100018309

Philip Ruck  
 Chief Executive  
 Brentwood Borough Council  
 Town Hall, Ingrave Road  
 Brentwood, CM15 8AY  
 Tel.: (01277) 312500

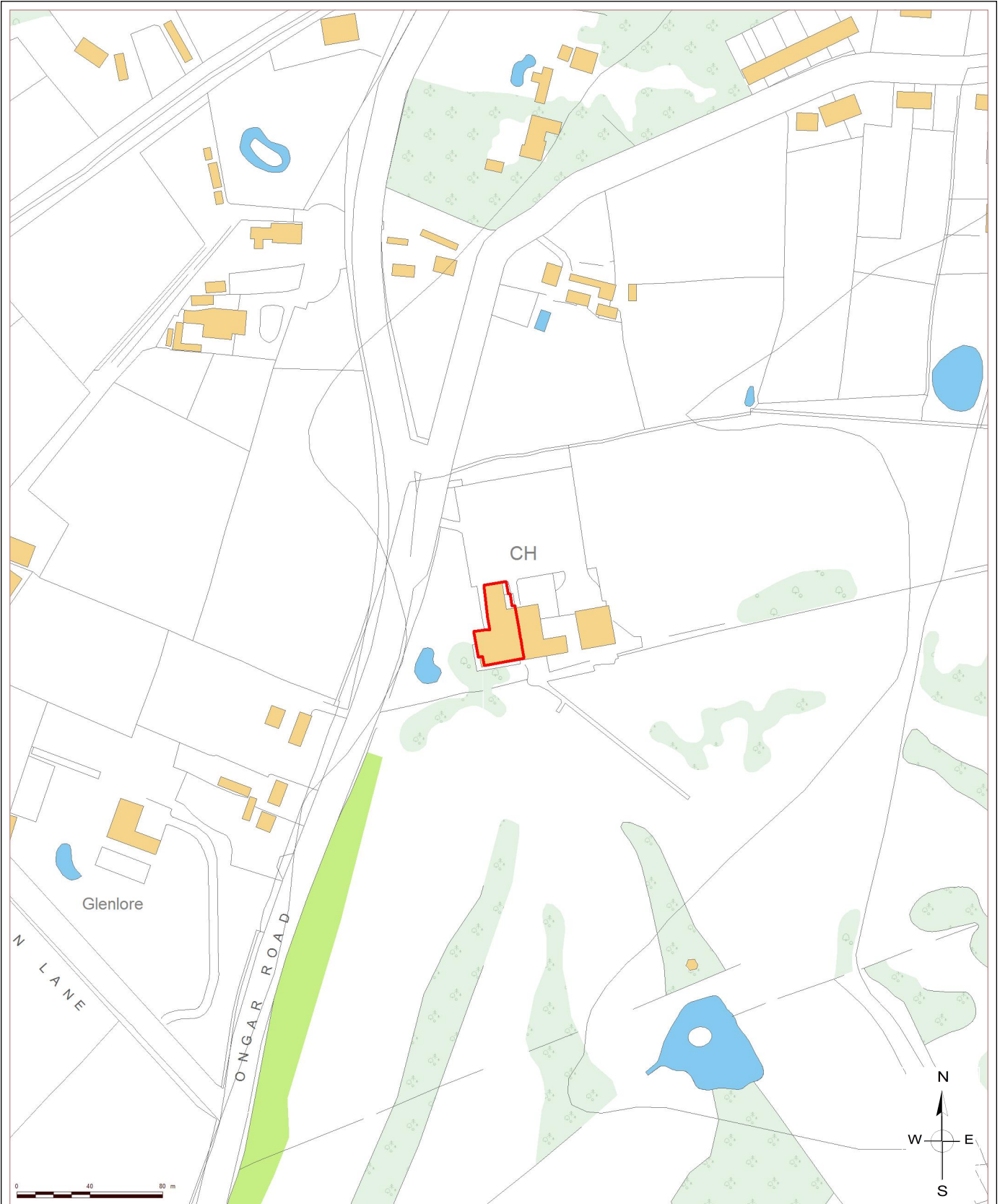

# DUSK, ONGAR ROAD, PILGRIMS HATCH CM15 9SS



Drawing No. :  
Scale at A4 : 1:3000  
Drawn by : OSJ  
Service : ICT  
Date : 19th August 2019

© Crown copyright and database rights 2018 Ordnance Survey 100018309

Philip Ruck  
Chief Executive  
Brentwood Borough Council  
Town Hall, Ingrave Road  
Brentwood, CM15 8AY  
Tel.: (01277) 312500

*DUSK*





*DUSK*





# duskloungeessex

## DUSK Brentwood

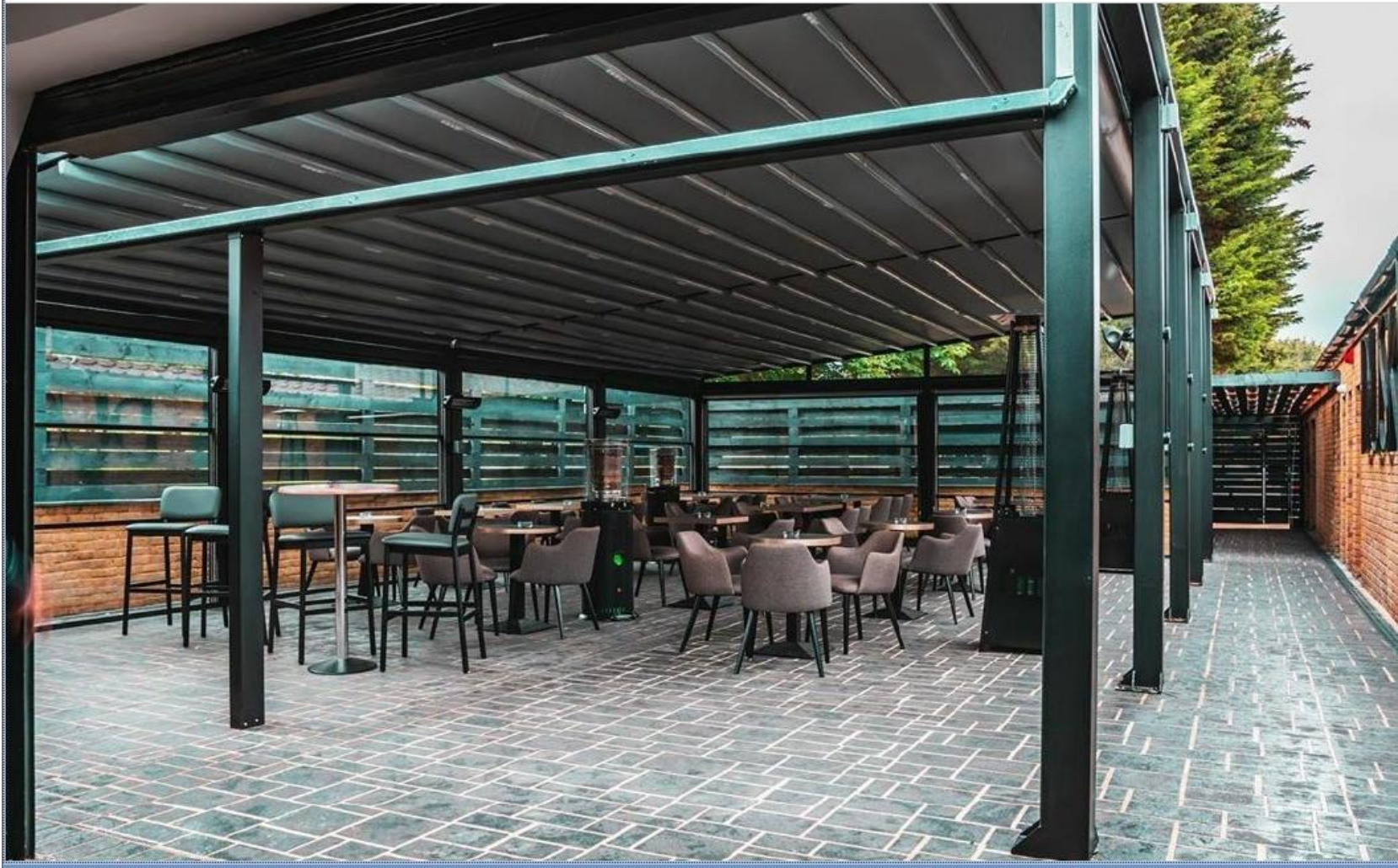





**duskloungeessex**  
**DUSK Brentwood**





**duskloungeessex**  
DUSK Brentwood





## Premises Licence

<b>Premises Licence Number</b>	<b>PRM_0569</b>
<b>Application Number</b>	<b>19/00072/LAPRE</b>
<b>Date of Issue</b>	<b>1 October 2019</b>

### Part 1 – Premises Details

Postal address of premises, or if none, ordnance survey map reference or description, including Post Town, Post Code
<b>Dusk Ongar Road Pilgrims Hatch Essex CM15 9SS</b>
Telephone number <b>01277 424987</b>

Where the licence is time limited the dates
---

Licensable activities authorised by the licence
<b>Performance of Dance Exhibition of a film Performance of Live music Playing of Recorded music Other Entertainment falling within Act Provision of Late Night Refreshments</b>

Times the licence authorises the carrying out of licensable activities
<b>Performance of Dance</b>
<b>Monday 16:00 - 00:00</b>
<b>Tuesday 16:00 - 00:00</b>
<b>Wednesday 16:00 - 00:00</b>
<b>Thursday 16:00 - 00:00</b>
<b>Friday 16:00 - 00:00</b>
<b>Saturday 16:00 - 00:00</b>
<b>Sunday 13:00 - 00:00</b>
<b>Exhibition of a film</b>
<b>Monday 16:00 - 00:00</b>
<b>Tuesday 16:00 - 00:00</b>
<b>Wednesday 16:00 - 00:00</b>
<b>Thursday 16:00 - 00:00</b>
<b>Friday 16:00 - 00:00</b>
<b>Saturday 16:00 - 00:00</b>
<b>Saturday 16:00 - 00:00</b>

**Performance of Live music**

<b>Monday</b>	<b>16:00 - 00:00</b>
<b>Tuesday</b>	<b>16:00 - 00:00</b>
<b>Wednesday</b>	<b>16:00 - 00:00</b>
<b>Thursday</b>	<b>16:00 - 00:00</b>
<b>Friday</b>	<b>16:00 - 00:00</b>
<b>Saturday</b>	<b>16:00 - 00:00</b>
<b>Sunday</b>	<b>13:00 - 00:00</b>

**Playing of Recorded music**

<b>Monday</b>	<b>16:00 - 00:00</b>
<b>Tuesday</b>	<b>16:00 - 00:00</b>
<b>Wednesday</b>	<b>16:00 - 00:00</b>
<b>Thursday</b>	<b>16:00 - 00:00</b>
<b>Friday</b>	<b>16:00 - 01:30</b>
<b>Saturday</b>	<b>16:00 - 01:30</b>
<b>Sunday</b>	<b>13:00 - 00:00</b>

**Other Entertainment falling within Act**

<b>Monday</b>	<b>16:00 - 00:00</b>
<b>Tuesday</b>	<b>16:00 - 00:00</b>
<b>Wednesday</b>	<b>16:00 - 00:00</b>
<b>Thursday</b>	<b>16:00 - 00:00</b>
<b>Friday</b>	<b>16:00 - 01:30</b>
<b>Saturday</b>	<b>16:00 - 01:30</b>
<b>Sunday</b>	<b>13:00 - 00:00</b>

**Provision of Late Night Refreshments**

<b>Monday</b>	<b>23:00 - 00:00</b>
<b>Tuesday</b>	<b>23:00 - 00:00</b>
<b>Wednesday</b>	<b>23:00 - 00:00</b>
<b>Thursday</b>	<b>23:00 - 00:00</b>
<b>Friday</b>	<b>23:00 - 01:30</b>
<b>Saturday</b>	<b>23:00 - 01:30</b>
<b>Sunday</b>	<b>23:00 - 00:00</b>

**The opening hours of the premises**

<b>Monday</b>	<b>16:00 - 00:00</b>
<b>Tuesday</b>	<b>16:00 - 00:00</b>
<b>Wednesday</b>	<b>16:00 - 00:00</b>
<b>Thursday</b>	<b>16:00 - 00:00</b>
<b>Friday</b>	<b>16:00 - 02:00</b>
<b>Saturday</b>	<b>16:00 - 02:00</b>
<b>Sunday</b>	<b>13:00 - 00:00</b>

Where the licence authorises supplies of alcohol whether these are on and / or off supplies

**Not Applicable**

## Part 2

Name, (registered) address, telephone number and email (where relevant) of holder of premises licence

**Sisu Enterprises Limited  
County Service Station  
Essex Gardens  
Hornchurch  
RM11 3EH**

**Email Address**

**info@duskbrentwood.co.uk**

Registered number of holder, for example company number, charity number (where applicable)

**Company Number**

**11278657**

Name, address and telephone number of designated premises supervisor where the premises licence authorises for the supply of alcohol

**Not Applicable**

Personal licence number and issuing authority of personal licence held by designated premises supervisor where the premises licence authorises for the supply of alcohol

**Not Applicable**



## **Annex 1 – Mandatory conditions**

- 1 The admission of children under the age of 18 to film exhibitions permitted under the terms of this licence shall be restricted in accordance with any recommendations made**
  - a) By the British Board of Film Classification (BBFC) where the film has been classified by that Board, or**
  - b) By the Licensing Authority where no classification certificate has been granted by the BBFC, or, where the licensing authority has notified the licence holder that section 20 (3) (b) (74 (3)9b) for clubs) of the Licensing Act 2003 applies to the film.**
- 2 Only individuals licensed by the Security Industry Authority may be used at the premises to guard against:**
  - a) Unauthorised access or occupation (eg through door supervision), or**
  - b) Outbreaks of disorder, or**
  - c) Damage**

## **Annex 2 – Conditions consistent with the Operating Schedule**

- 1 The premises shall have installed and maintain a closed circuit television surveillance (CCTV) system which at all times complies with the below requirements:**
  - i. CCTV will be provided in the form a recordable system, capable of providing pictures of evidential quality in all lighting conditions particularly facial recognition;**
  - ii. CCTV cameras shall cover all entrances and exits;**
  - iii. Equipment must be maintained in good working order, be correctly time and date stamped, recordings must be kept in good working order and kept for a minimum period of 31 days;**

**Upon the reasonable request of the police or licensing authority staff, within 48 hours viewable copies of recordings will be provided.**

- 2 Signs must be displayed at all entrances advising customers that CCTV is operating at the premises and shall be a minimum size of 200 x 148 mm and clearly legible at all times when the premises conducts licensable activities.**
- 3 An incident log shall be kept at the premises, and made immediately available to police or licensing authority staff upon reasonable request.**

**The log must be completed as soon as is possible and within any case within 4 hours of the occurrence and shall record the following:**

- (a) all crimes reported to the venue**
- (b) all ejections of patrons**
- (c) any complaints received concerning crime and disorder**
- (d) any incidents of disorder**
- (e) all seizures of drugs, offensive weapons or alcohol**
- (f) any faults in a CCTV system, searching equipment or scanning equipment mandated as a condition of the licence**

**The incident log shall either be electronic or maintained in a bound document with individually numbered pages and be retained for at least 12 months from the date of the last entry.**

- 4 Where SIA licensed door supervisors are used at the premises a record shall be maintained (on the premises) which is legible and details:**
  - i. The day and date when door supervisors were deployed;**
  - ii. The name and SIA registration number of each door supervisor on duty at the premises; and**
  - iii. The start and finish time of each door supervisor's worked duty period.**

**This record shall be retained on the premises for 31 days and be immediately provided to police or licensing authority staff upon reasonable request.**

- 5 Where SIA licensed door supervisors are employed at the premises (either directly or via a third party) a check of the current validity of each door supervisor's licence shall be conducted via the SIA website at the commencement of employment at the premises and monthly thereafter and recorded in a log.**

**This log shall be retained for at least 6 months after the last recorded check and be immediately provided to police or licensing authority staff upon reasonable request.**

- 6 At all times drinks must only be served in polycarbonate/plastic and/or toughened glass containers.**
- 7 Clear and legible notices must be prominently displayed at all exits requesting customers to respect local residents and leave the area quietly.**

**These signs shall be a minimum size of 200mm x 148 mm.**

- 8 A Challenge 25 scheme shall be operated, whereby any person who appears to be under the age of 25 years of age is required to produce on request an item which meets the mandatory age verification requirement and is either a:**
- o Proof of age card bearing the PASS Hologram;**
  - o Photocard driving licence;**
  - o Passport; or**
- Ministry of Defence Identity Card.**
- 9 The premises shall clearly display signs at the each point of sale and in areas where alcohol is displayed advising customers that a 'Challenge 25' policy is in force.**

**At the point of sale, such signs shall be a minimum size of 200mm x 148mm.**

- 10 All staff shall have received training in relation to the protection of children from harm (including under-age sales), how to recognise drunkenness and the duty not to serve drunk persons. Refresher training shall be carried out at least every six months.**

**Training records shall be kept on the premises (or otherwise be accessible on the premises) for a minimum of 12 months and made immediately available to police, trading standards or licensing authority staff upon reasonable request.**

- 11 On leaving patrons will be chaperoned to their vehicles to minimise disruption and noise outside.**



## **Annex 3 – Conditions attached after a hearing by the licensing authority**

- 1 There should be a second interior door installed at the front entrance.**

### **In reference to the outside area there shall be the following additional conditions**

- 2 The retractable roof will be completely shut/closed by 2100hrs each day.**
- 3 There shall be no use of the outside space on Sunday to Thursday after 2230hrs and on Friday and Saturday after 0000hrs except for the purpose of smoking.**
- 4 The area is to be staffed when it is being used.**
- 5 There shall be no licensable recorded music after 2230hrs each day.**
- 6 The passageway will be staffed at times of use.**
- 7 Noise limiters shall be installed in the outside space in discussion and agreement of the Licensing Department of the Council.**
- 8 Signage to be displayed requesting patrons to use courtesy and respect to neighbours.**

# Annex 4 – Plans

This licence is issued subject to the following attached plan dated 13.07.18 marked **Joy Fook, Ongar Road, Essex CM15 9SS**

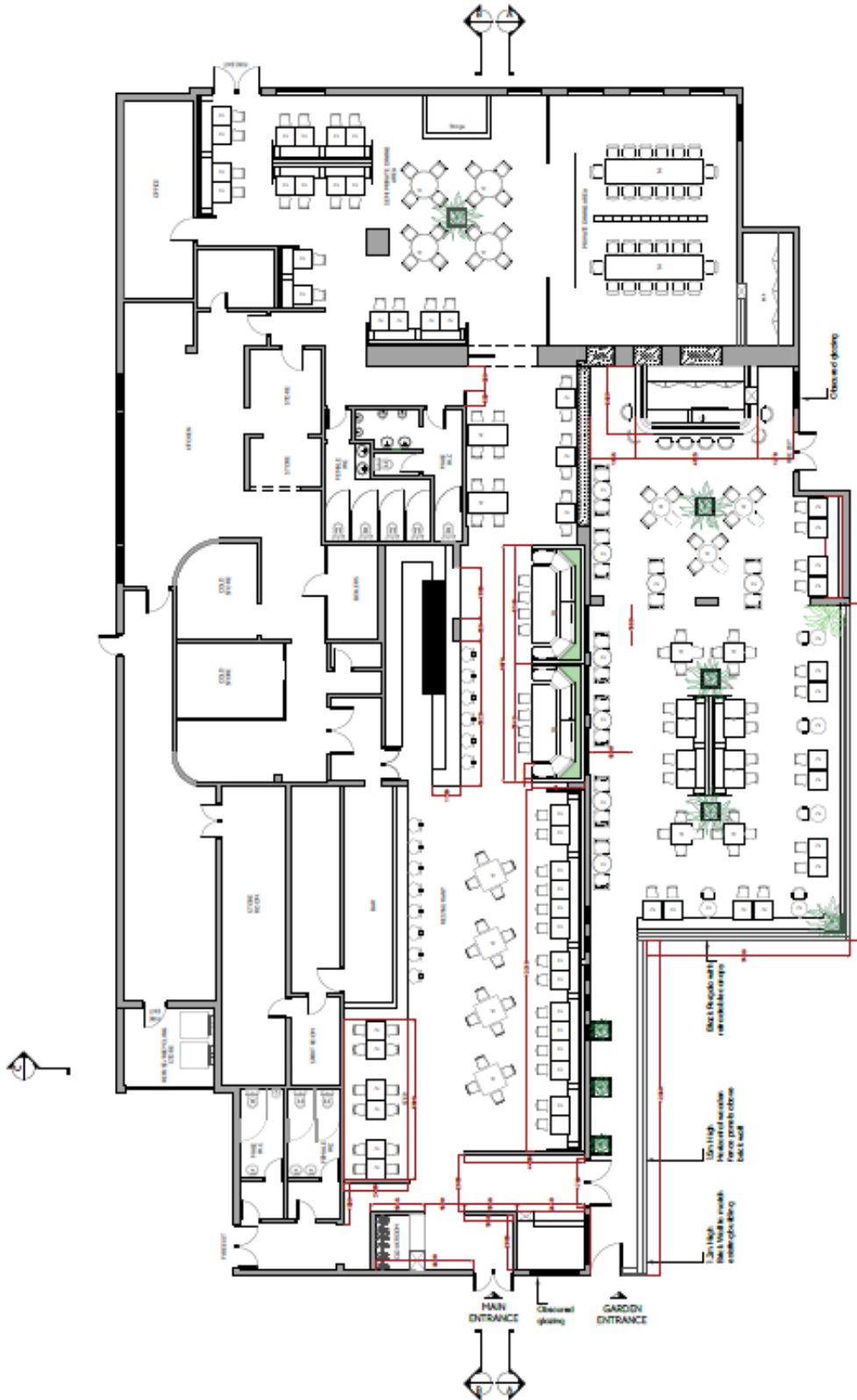



## Premises Licence Summary

<b>Premises Licence Number</b>	<b>PRM_0569</b>
<b>Application Number</b>	<b>19/00072/LAPRE</b>
<b>Date of Issue</b>	<b>1 October 2019</b>

### Part 1 – Premises Details

Postal address of premises, or if none, ordnance survey map reference or description, including Post Town, Post Code

**Dusk**  
**Ongar Road**  
**Pilgrims Hatch**  
**Essex CM15 9SS**

Telephone number  
**01277 424987**

Where the licence is time limited the dates

Licensable activities authorised by the licence

**Performance of Dance**  
**Exhibition of a film**  
**Performance of Live music**  
**Playing of Recorded music**  
**Other Entertainment falling within Act**  
**Provision of Late Night Refreshments**

Times the licence authorises the carrying out of licensable activities

### Performance of Dance

<b>Monday</b>	<b>16:00 - 00:00</b>
<b>Tuesday</b>	<b>16:00 - 00:00</b>
<b>Wednesday</b>	<b>16:00 - 00:00</b>
<b>Thursday</b>	<b>16:00 - 00:00</b>
<b>Friday</b>	<b>16:00 - 00:00</b>
<b>Saturday</b>	<b>16:00 - 00:00</b>
<b>Sunday</b>	<b>13:00 - 00:00</b>



**Exhibition of a film**

<b>Monday</b>	<b>16:00 - 00:00</b>
<b>Tuesday</b>	<b>16:00 - 00:00</b>
<b>Wednesday</b>	<b>16:00 - 00:00</b>
<b>Thursday</b>	<b>16:00 - 00:00</b>
<b>Friday</b>	<b>16:00 - 00:00</b>
<b>Saturday</b>	<b>16:00 - 00:00</b>
<b>Saturday</b>	<b>16:00 - 00:00</b>

**Performance of Live music**

<b>Monday</b>	<b>16:00 - 00:00</b>
<b>Tuesday</b>	<b>16:00 - 00:00</b>
<b>Wednesday</b>	<b>16:00 - 00:00</b>
<b>Thursday</b>	<b>16:00 - 00:00</b>
<b>Friday</b>	<b>16:00 - 00:00</b>
<b>Saturday</b>	<b>16:00 - 00:00</b>
<b>Sunday</b>	<b>13:00 - 00:00</b>

**Playing of Recorded music**

<b>Monday</b>	<b>16:00 - 00:00</b>
<b>Tuesday</b>	<b>16:00 - 00:00</b>
<b>Wednesday</b>	<b>16:00 - 00:00</b>
<b>Thursday</b>	<b>16:00 - 00:00</b>
<b>Friday</b>	<b>16:00 - 01:30</b>
<b>Saturday</b>	<b>16:00 - 01:30</b>
<b>Sunday</b>	<b>13:00 - 00:00</b>

**Other Entertainment falling within Act**

<b>Monday</b>	<b>16:00 - 00:00</b>
<b>Tuesday</b>	<b>16:00 - 00:00</b>
<b>Wednesday</b>	<b>16:00 - 00:00</b>
<b>Thursday</b>	<b>16:00 - 00:00</b>
<b>Friday</b>	<b>16:00 - 01:30</b>
<b>Saturday</b>	<b>16:00 - 01:30</b>
<b>Sunday</b>	<b>13:00 - 00:00</b>

**Provision of Late Night Refreshments**

<b>Monday</b>	<b>23:00 - 00:00</b>
<b>Tuesday</b>	<b>23:00 - 00:00</b>
<b>Wednesday</b>	<b>23:00 - 00:00</b>
<b>Thursday</b>	<b>23:00 - 00:00</b>
<b>Friday</b>	<b>23:00 - 01:30</b>
<b>Saturday</b>	<b>23:00 - 01:30</b>
<b>Sunday</b>	<b>23:00 - 00:00</b>

The opening hours of the premises

<b>Monday</b>	<b>16:00 - 00:00</b>
<b>Tuesday</b>	<b>16:00 - 00:00</b>
<b>Wednesday</b>	<b>16:00 - 00:00</b>
<b>Thursday</b>	<b>16:00 - 00:00</b>
<b>Friday</b>	<b>16:00 - 02:00</b>
<b>Saturday</b>	<b>16:00 - 02:00</b>
<b>Sunday</b>	<b>13:00 - 00:00</b>

Where the licence authorises supplies of alcohol whether these are on and / or off supplies

**Not Applicable**

Name, (registered) address of holder of premises licence

**Sisu Enterprises Limited  
County Service Station  
Essex Gardens  
Hornchurch  
RM11 3EH**

**Email Address**

**info@duskbrentwood.co.uk**

Registered number of holder, for example company number, charity number (where applicable)

**Company Number**

**11278657**

Name of designated premises supervisor where the premises licence authorises for the supply of alcohol

**Not Applicable**

Personal licence number and issuing authority of personal licence held by designated premises supervisor where the premises licence authorises for the supply of alcohol

**Not Applicable**

State whether access to the premises by children is restricted or prohibited